

NATIONAL
PLASTICS & RUBBER

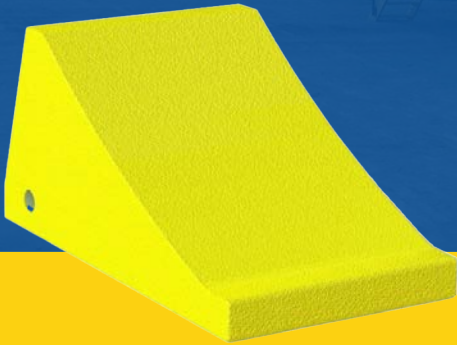

WHEEL CHOCKS

Leaders in the design and manufacture of Polyurethane,
Rubber and Industrial Plastic products.

WHEEL CHOCKS

WORLD CLASS CHOCKS

National Plastics & Rubber's Wheel Chocks are tough and durable. With sizes to cover almost every application from smaller site vehicles to the largest mining trucks.

>> LIGHTWEIGHT

>> FIELD TESTED

>> SLIP-RESISTANT, DURABLE
POLYURETHANE

>> ONE-PIECE CONSTRUCTION

>> IMPERVIOUS TO CHEMICALS,
SALTS AND ROT

>> RESISTANT TO FUEL, OIL AND
SOLVENTS

>> WIDE RANGE OF SIZES TO SUIT
EVERY APPLICATION



LIGHT VEHICLES

SIZE 1.5LW

PART NO. NPR01895-00



Suits Tyres

⊘ 400mm to 800mm



BRACKET OPTIONS



NPR01945-00



NPR02034-00

180mm L

115mm W

110mm H

0.7kg

SIZE 2LW

PART NO. NPR01180-00

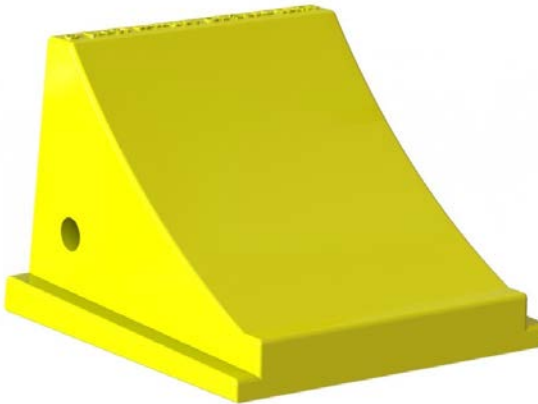

Suits Tyres

⊘ 400mm to 900mm



BRACKET OPTIONS



NPR01951-00



NPR01236-00

210mm L

200mm W

150mm H

1.6kg

MEDIUM VEHICLES

SIZE 3LW
PART NO.
NPR01181-00



Suits Tyres

⊘ 900mm to 1400mm



BRACKET OPTIONS



NPR02013-00



NPR01237-00

340mm L

220mm W

200mm H

3.5kg

SIZE 3.5LW
PART NO.
NPR02097-00

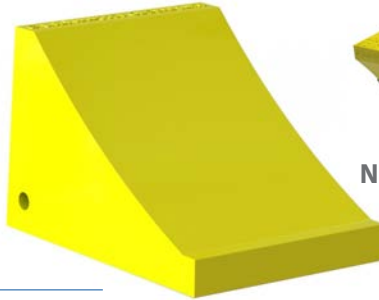

Suits Tyres

⊘ 1200mm to 1800mm



BRACKET OPTION



NPR02266-00



NPR02264-00

340mm L

250mm W

225mm H

6.2kg

SIZE 3.7LW
PART NO.
NPR01891-00

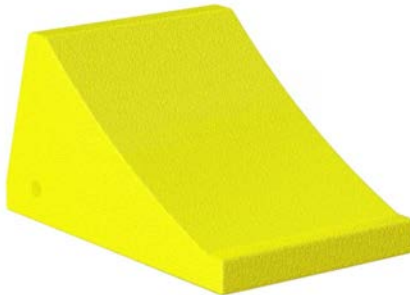

Suits Tyres

⊘ 1200mm to 2200mm



BRACKET OPTION



NPR01944-00

475mm L

305mm W

255mm H

6kg

LARGE - X LARGE VEHICLES

SIZE 4LW
PART NO.
NPR01329-00



Suits Tyres

⊘ 1800mm to 3000mm



BRACKET OPTION



NPR02016-00

570mm L

340mm W

280mm H

9kg

SIZE 5LW
PART NO.
NPR02155-00



Suits Tyres

⊘ 2200mm to 3500mm



BRACKET OPTION



NPR02136-00

621mm L

343mm W

323mm H

11kg

SIZE 6LW
PART NO.
NPR00984-00



Suits Tyres

⊘ 2800mm to 4200mm



BRACKET OPTION



NPR02017-00

680mm L

337mm W

355mm H

14kg

XX LARGE VEHICLES

SIZE 7LW
PART NO.
NPR05024-00



Suits Tyres

⊘ 2800mm to 4500mm



BRACKET OPTION



NPR05535-00

▣ 445mm L

▣ 385mm W

▣ 400mm H

⚖ 16kg

MEDIUM - LARGE VEHICLES

SIZE 4/3LW
PART NO.
NPR01476-00



Suits Tyres

⊘ 2800mm to 4500mm



BRACKET OPTION



NPR02029-00

▣ 559mm L

▣ 330mm W

▣ 280mm H

⚖ 8kg

WHEEL CHOCK USER GUIDE

PLEASE READ THIS GUIDE BEFORE USING WHEEL CHOCKS

1. PERFORM RISK ASSESSMENT FIRST

- >> Confirm the Wheel Chock is the correct size for the tyre diameter
- >> Always use an adequate amount of Wheel Chocks to suit your requirements

2. INSPECT YOUR WHEEL CHOCKS

- >> Ensure all Wheel Chocks are free from damage and have all components



3. RECOMMENDED WHEEL CHOCKING

LEVEL SURFACE

- >> Ensure all Wheel Chocks are placed centrally to the tyre in a parallel position
- >> Ensure you are on a level surface before placing Wheel Chocks
- >> Chock both sides of the tyres - front and back

GRADIENT SURFACES - LOADED VEHICLES

>> Place 4 Wheel Chocks on the downhill side on each tyre



GRADIENT SURFACES - UNLOADED VEHICLES

>> Place 2 Wheel Chocks on the downhill side on the outer 2 tyres



WHEEL CHOCK BRACKETS

>> Wheel Chocks can be stored in Brackets while not in use



WORKSHOP WHEEL CHOCK

IMPROVE YOUR WORKSHOP SAFETY

We have expanded our trusted Wheel Chock range to include an ergonomically designed Workshop Wheel Chock. Complimenting our range of quality tested mining products, this chock is purpose designed for the workshop environment.

- >> REDUCES RISK OF BACK STRAIN CAUSED BY REPEAT BENDING
- >> EASIER TO ENSURE CORRECT POSITIONING
- >> ELIMINATE THE NEED TO GO UNDER THE FOOTPRINT OF THE TRUCK
- >> IDEAL FOR TYPICAL WORKSHOP ENVIRONMENTS AND LOW GRADIENTS



AWARD-WINNING PRODUCT

Innovation & People's Choice Award QLD Mining Health & Safety Conference 2022

WORKSHOP WHEEL CHOCK

PART NO. NPR 07999-00

34kg

SIZE 4 WORKSHOP WHEEL CHOCK

PART NO. NPR 08304-00

Designed to suit equipment with smaller tyre widths (Graders and small trucks)

21kg



USER GUIDE

National Plastics & Rubber promotes safe working practices therefore, performing your own risk assessment is essential before using these products.



To move into position, pull the handle down, levering the Workshop Wheel Chock onto its back wheels.

Push the Workshop Wheel Chock as close to the truck wheel as possible.



Lift the Workshop Wheel Chock onto its front wheel and bring close to the tyre. Bring the back of the chock around into position.

The chock should be straight and flush against the bottom of the tyre.

Ensure both sides of the wheel are chocked.



When chocks on both sides of the wheel are in position correctly, the truck is secured.

To remove the chock, lift onto front wheel, remove from flush position and when clear of the tyre, transition onto the back wheels and move into selected location.



NATIONAL PLASTICS & RUBBER

NATIONALPLASTICS.NET.AU

Email info@nationalplastics.net.au **Phone** 07 3279 3066

National Plastics & Rubber has the experience and knowledge necessary to meet your needs.

National Plastics & Rubber promotes safe working practices therefore, performing your own risk assessment is essential before using these products.

We specialise in polyurethane, rubber and industrial plastics design and manufacturing for the mining, automotive and manufacturing industries.